

TE 526 3D

made of solid stainless steel for  
unrebated heavy-duty doors



Product features

- material stainless steel
- completely concealed hinge system
- for timber, steel or aluminium frames
- for unrebated heavy-duty doors
- 3D adjustment (side +/- 3.0 mm, height +/- 3.0 mm, compression +/- 1.0 mm)
- maintenance-free slide bearings

Technical data

Property	Value
Load capacity	120.0 kg
Overall length	155.0 mm
Width (door part)	26.0 mm
Width (frame part)	26.0 mm
Cutter diameter	24.0 mm
Collar ring diameter	30.0 mm
Opening angle	180°

Notes

Quality marks

 CE certification

 IFT certification

 UL certification

 Certifire certification

 UKCA certification

Classification code

4	7	6	1 <sup>1</sup>	1	4	1	13
---	---	---	----------------	---	---	---	----

<sup>1</sup> Test evidence for functional doors to be achieved with full door sets and assemblies.

**TECTUS - TE 526 3D**

The load capacity mentioned above refers to the use of 2 hinges per door leaf (1 x 2 m), for detailed information please look at the chapter "technical information".

With an opening position of 180° the door may have to be fixed additionally.

Also available in Satin Stainless Steel grade 316.

**Installation tools**

Universal milling frame

Drilling jig TECTUS TE 526/527 3D

Template 5 250547 6

block frame and blind frame

frame / door

**Combinations**

TE 526/527 3D FZ

TE 526/527 3D SZ

TE 526/527 3D ST

Intumescent Kit - Ref. 8820

**Function range**

Burglar resistance



Fire resistance



Smoke resistance



Soundproof

**Item versions**

Finish

Satin Stainless Steel (SW 040)

VPE

Pack of 2

DIN

DIN right and left hand

Article number

5 400561 0 04002

EAN

4015471110703

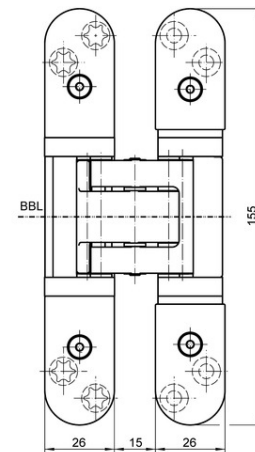

front view

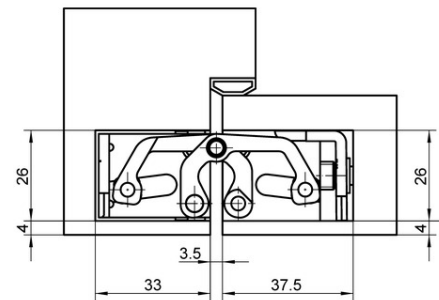

block frame

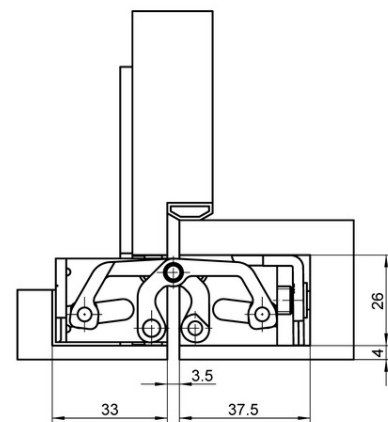

casing frame

**TECTUS - TE 526 3D**

Finish	pol. Stainless Steel (SW 042)
VPE	Pack of 2
DIN	DIN right and left hand
Article number	5 400561 0 04202
EAN	4015471120061

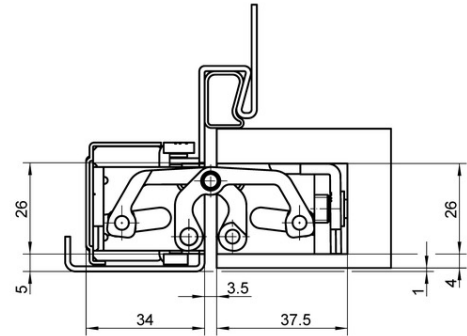

steel frame

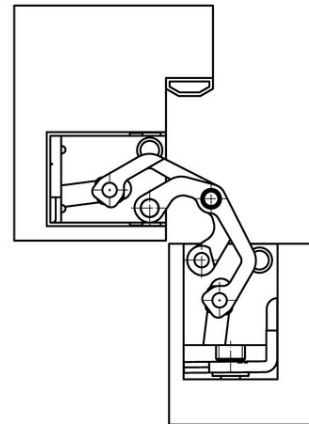

block frame 90°

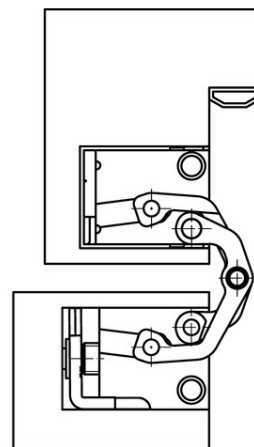

block frame 180°